

PRODUCED BY AN AUTODESK EDUCATIONAL PRODUCT

VENICE

WESTERN

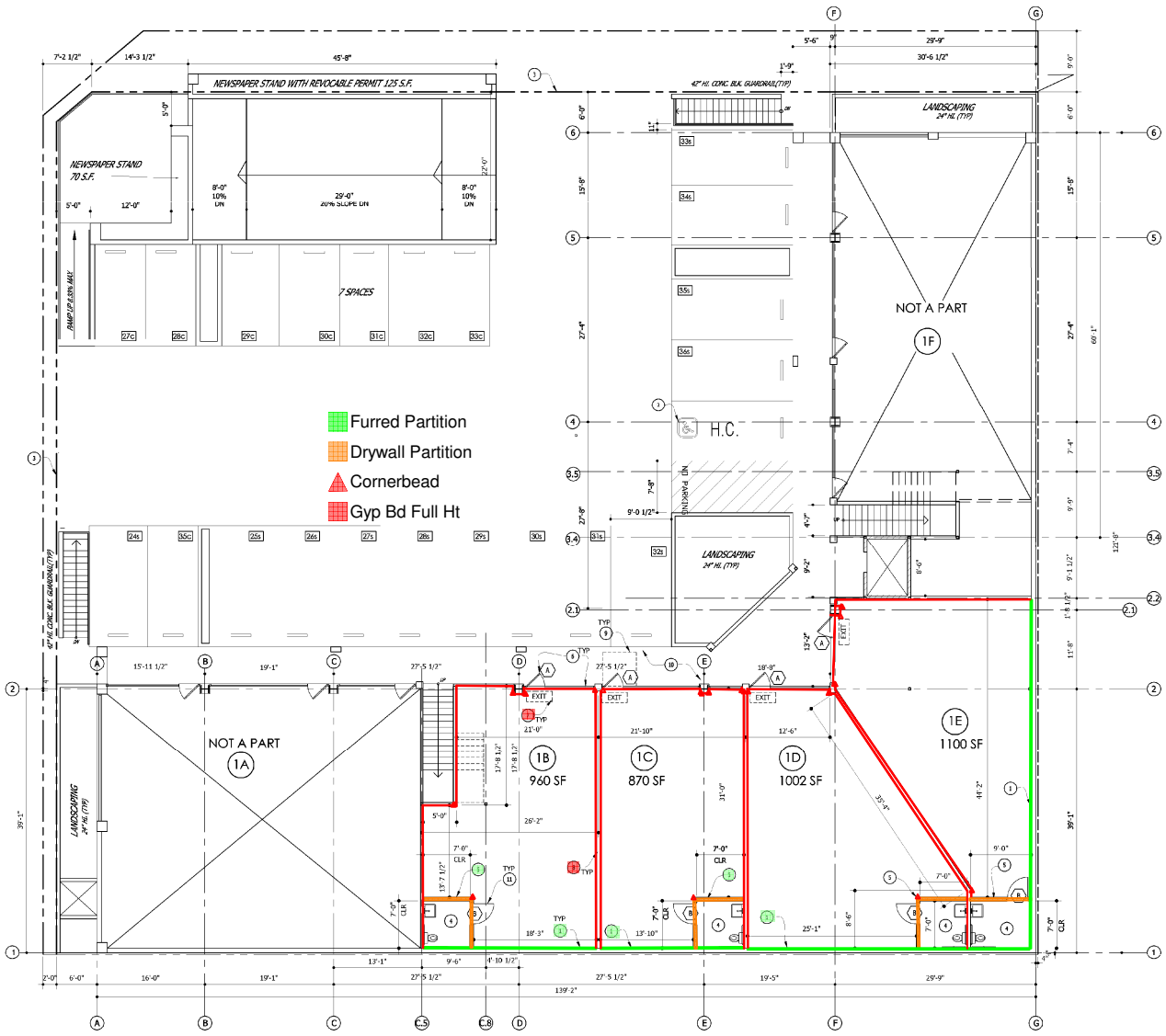

FLOOR PLAN KEY NOTES

- 1 EXISTING 6" CMU BLOCK WALL. PROVIDE 5/8" THK GYP BD FURRING ON TOP @ 12" O.C. METAL FURRING CHANNELS @ 16" O.C. EXTEND GYPSUM WALL BOARD TO 6" ABOVE CEILING
- 2 EXISTING H/C STALLS TO REMAIN
- 3 PROPERTY LINE
- 4 NEW TOILET ROOM PLAN, REFER TO SHEET A-3.0
- 5 6" MET STUD (20ga @ 16" O.C.) MET STUD WALL W/ FIB SOUND INSUL. ALL THE WAY UP TO COF DECK.
- 6 EXISTING ALUMINUM STOREFRONT AND DOOR TO REMAIN. VERIFY ADA COMPLIANCE PER DETAIL
- 7 ILLUMINATED EXIT SIGN WITH MIN 5 FT CANDLES INTENSITY WITH BATTERY BACK-UP. SEE ELEC.
- 8 EXISTING DEMISING WALL TO REMAIN
- 9 VERIFY 5X5' LEVEL LANDING AT EXIT DOORS WITH 2% MAX CROSS SLOPE
- 10 EXISTING CONCRETE SIDEWALK TO REMAIN
- 11 NEW DOOR AT RESTROOM. SEE DOOR TYPES DETAIL

- LEGEND**
- (A) DOOR TYPE. SEE 1/A46 FOR DOOR SCHEDULE
  - SEE 7/A39 FOR ROOM FINISH SCHEDULE

ARCHITECT

Bala Vairavan Architects Inc.  
4915 COLUMBIAN CANYON, STE 3  
SHERMAN OAKS, CA 91403  
TEL: (818) 205-7420

THIS DRAWING IS THE EXCLUSIVE PROPERTY OF BVA INC. THE INFORMATION SHOWN MAY NOT BE USED FOR THE DRAWINGS REPRODUCED WITHOUT BVA INC'S WRITTEN CONSENT. COPYRIGHT: BALA VAIRAVAN ARCHITECTS INC. ALL RIGHTS RESERVED.

PROJECT

**VANILLA SHELL IMPROVEMENTS**

VENICE & WESTERN COMMERCIAL CENTER  
1570 S WESTERN AVENUE  
LOS ANGELES, CA 90006

DWNN

**SILVER PENINSULA CORNER LLC**

11601 WILSHIRE BLVD, STE 1900  
LOS ANGELES, CA 90025

01/25/08 PLAN CHECK ISSUE

NOT FOR CONSTRUCTION

REVISIONS

DRAWING TITLE

**FIRST FLOOR PLAN**

BVA JOB # 08-001

SCALE: DATE: 01/25/08

SHEET NUMBER

**A-1.0**

FIRST FLOOR PLAN

SCALE 1/8" = 1'-0" 2

FLOOR PLAN KEY NOTES

SCALE NONE 1

PRODUCED BY AN AUTODESK EDUCATIONAL PRODUCT